

Viking Johnson Tapping and Repair Clamps

Technical Guide W5.2

Viking Johnson EasiTap and EasiClamp repair clamps are a comprehensive range of world class, permanent, under pressure repair and tapping solutions.

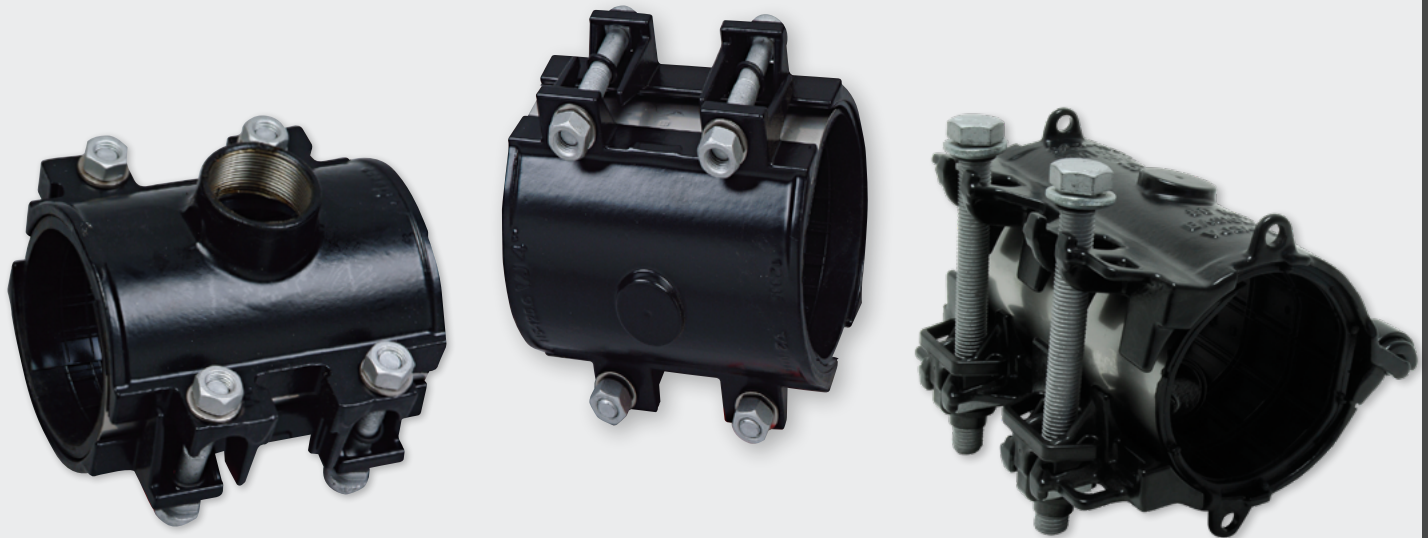

01.24 | W5.2 EASI RANGE PIPE TAPPING AND REPAIR COUPLERS

Applications

Pipeline repair
Pipeline lateral connections

Product Attributes

Suits a wide range of pipe materials
A reliable seal with waffle gasket
Can be installed under pressure from outside the trench
Sheraplex nuts & bolts standard

Approvals/Standards

WRAS, AS/NZS 4020

Quality

ISO 9001:2008 Quality Management
ISO 14001 Environmental Management

We are the supply partner of choice for New Zealand's civil construction industry, specialising in water and infrastructure based solutions.

HYNDSwater

Viking Johnson EasiTap and EasiClamp repair clamps are a comprehensive range of world class, permanent, under pressure repair and tapping solutions.

Design Specifications

- Suitable for most Cast Iron, Ductile Iron, Steel, PVC and AC pipes (depending on outside diameter)
- Unique 100% circumferential "Waffle" gasket provides a leak tight seal and caters for circumferential or longitudinal cracks
- Up to 24 mm tolerance
- 16 bar working pressure (water)
- Self retaining bolts reduce the potential loss of bolts during installation
- No specialist installation equipment is required, just a torque wrench to confirm correct bolt torque
- Accelerated age tests (AAT) to verify 50 years design life expectancy
- PN16 rated

Materials and Relevant Standards

Housing

- Tapped Housing - Ductile Iron to BS EN 1563
SYMBOL EN-GJS-450-10 or
Malleable Cast Iron to BS EN 1562
- SYMBOL EN-GJMB-350-10 (D&T outlet only)
Plain Housing - Ductile Iron to BS EN 1563
SYMBOL EN-GJS-450-10

Bridging Plate

- Stainless Steel to BS1449: Part 2 Grade 304S15 2B Finish

Gasket

- Grade E, 60 IRHD EPDM to BS2494 W+D

Bolts/Bolt Torque/Spanner Size

- Standard - Steel to BS EN ISO 898-1 Property Class 4.8
- Option - Stainless Steel to BS EN ISO3506-1 Grade A2 Property Class 70
 - M12 = 55 to 65Nm / A/F 19mm
 - M16 = 95 to 110Nm / A/F 24mm
- Nuts
 - Standard - Steel to BS 4190 Grade 4
 - Option - Stainless Steel to BS EN ISO3506-2 Grade A4 Property Class 80
- Washers
 - Standard - Stainless Steel to BS 1449:Part 2 Grade 304 S15
 - Option - Stainless Steel to BS EN ISO3506-1 Grade A2 Property Class 50

Coating

- Tapped Housing - Rilsan Nylon 11 to WIS 4-52-01 (Part1)
- Plain Housing - Rilsan Nylon 11 to WIS 4-52-01 (Part1)
- Bolts & Nuts - Sheraplex to WIS 4-52-03

Approvals

All water contact materials are WRAS and AS/NZS 4020 approved for use with potable water.

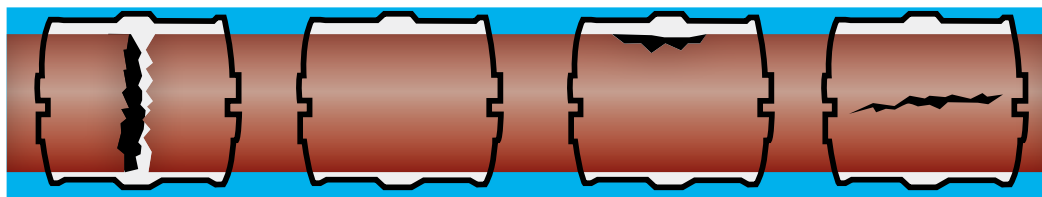

Circumferential breaks

Corrosion holes

Impact damage

Longitudinal cracks

EasiBoss and EasiClamp

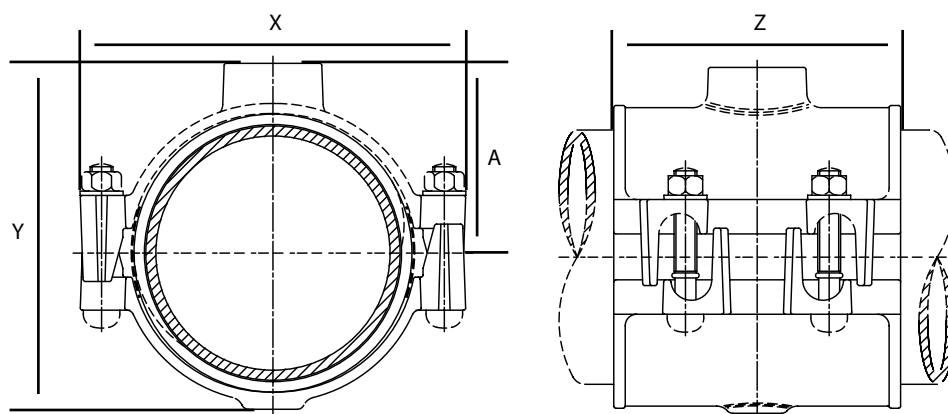

FIG. 1 Easi Boss

TABLE 1 Easi Boss

Code	DN	OD Range Min-Max (mm)	X (mm)	Y Max (mm)	Z (mm)	Bolt Size No.- Dia x Length	Outlet BSP Threaded Size	Weight (kg)
EC100T50	100	115-125	211	167	200	4-M16 x 95mm	2"	6
EC150T50	150	166-181	267	217	200	4-M16 x 95mm	2"	8.3
EC200T50S	200	216-226	313	269	200	4-M16 x 95mm	2"	9.5
EC200T50	200	230-243	328	281	200	4-M16 x 95mm	2"	10.8
EC225T50	225	243-267	362	307	212	4-M16 x 120mm	2"	13.6
EC250T50	250	269-294	395	322	250	6-M16 x 120mm	2"	18.5
EC300T50	300	323-349	450	387	300	8-M16 x 120mm	2"	25.2

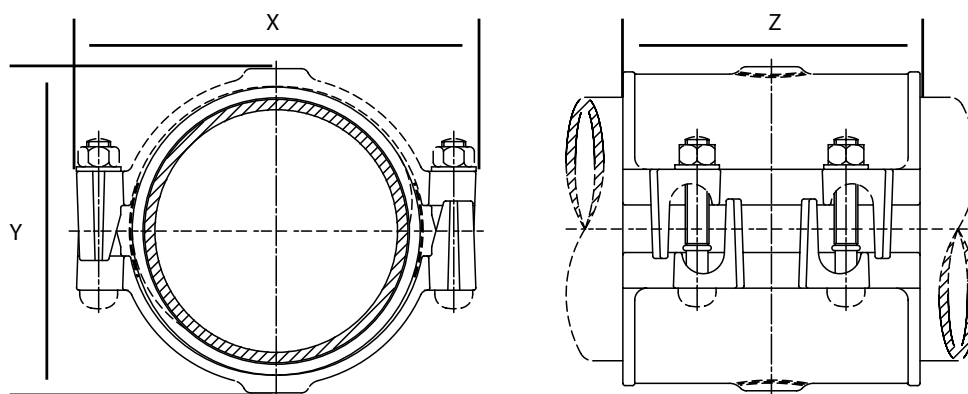

FIG. 2 Easi Clamp

TABLE 2 Easi Clamp

Code	DN	OD Range Min-Max (mm)	X (mm)	Y Max (mm)	Z (mm)	Bolt Size No.- Dia x Length	Outlet BSP Threaded Size	Weight (kg)
EC050	50	66-75	150	110	200	4-M12 x 65	3/4"	4.1
EC125	125	141-154	239	182	200	4-M16 x 95	2"	7.5
EC175	175	200-210	296	238	200	4-M16 x 95	2"	9
EC200	200	216-226	313	269	200	4-M16 x 95	2"	9.5
EC200L	200	230-243	328	281	200	4-M16 x 95	2"	10.8
EC225	225	243-267	362	307	212	4-M16 x 120	2"	13.6
EC250	250	269-294	395	322	250	6-M16 x 120	2"	18.5
EC300	300	323-349	450	387	300	8-M16 x 120	2"	25.2

Remote Easi Clamp

Working Pressure = 16bar (water)

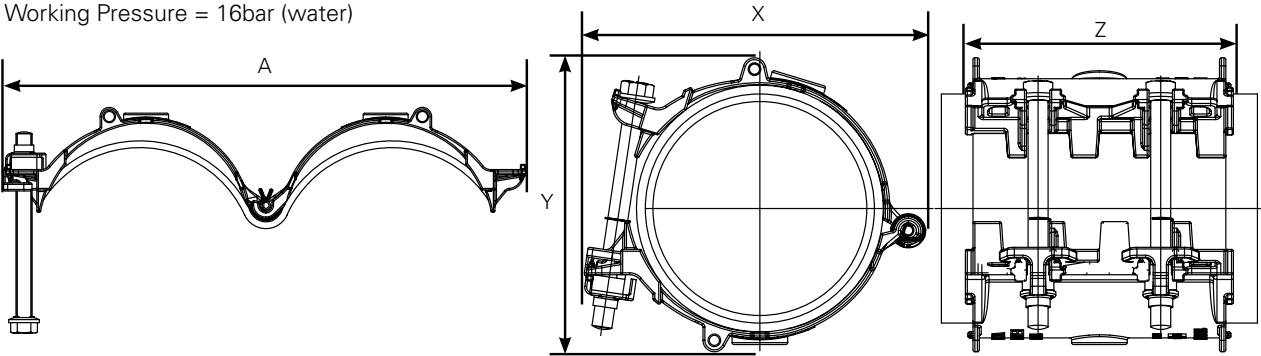

FIG. 3

TABLE 3 Remote Easi Clamp

Code	DN	OD Range Min-Max (mm)	X (mm)	Y Max (mm)	Z (mm)	A (mm)	Bolt Size No.- Dia x Length	Gasket Mould No.	Weight (kg)
EC080	80	92-103	182	175	212	347	2-M16 x 165	13094	4.8
EC100	100	115-125	207	186	212	395	2-M16 x 165	13095	5.3
EC150	150	162-181	264	233	212	512	2-M16 x 185	13096	6.9

Branches Nationwide Support Office & Technical Services 0800 93 7473

Disclaimer: While every effort has been made to ensure that the information in this document is correct and accurate, users of Hynds product or information within this document must make their own assessment of suitability for their particular application. Product dimensions are nominal only, and should be verified if critical to a particular installation. No warranty is either expressed, implied, or statutory made by Hynds unless expressly stated in any sale and purchase agreement entered into between Hynds and the user.