

Dog Bowl



Hynds Code	Dimensions
DOGBOWLN	410 x 150 x 130
	Litres
	10
	Weight
	20

Feed Troughs



Hynds Code	Dimensions
TPIGPF	1080 x 380 x 180
	Litres
	37
	Weight
	95



Hynds Code	Dimensions
TPIGMMC*	920 x 415 x 230
	Litres
	55
	Weight
	80



Handling and Installing Guideline



1. Store and transport the troughs in a flat position.
2. Lift the troughs, do not drag or push them.
3. Use appropriate lifting clutches and chains for this purpose.
4. Care must be taken when moving troughs over uneven ground as not designed for dynamic loads.
5. Prepare area, by creating a stable and even base.
6. Select inlet option and place plug in alternative inlet.
7. Place trough with care.
8. Verify that the trough is sitting level.
9. Connect the trough valve and water supply as per the manufacturer's instructions.
10. Care must be taken to ensure cross-threading doesn't occur when fitting the valves and pipe connection.
11. Once installed, test and check for leaks.
12. Regular maintenance and checks help ensure the long-term durability of the product.



SL1.3 CHAINSLING3X2.0
SL2.5

All Hynds Skid Ring Joint Concrete Pipes feature certified concrete lifting anchor systems, designed and tested to guarantee safe and secure handling.



hyndsrural.co.nz



Trough Brochure



Trough Round Protected*

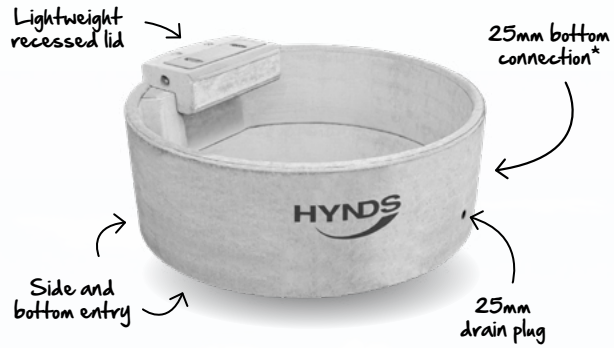

Hynds Code	Dimensions	Litres	Weight
TRP0515LNIM	1600 x 426	515	742
TRP0750LNIM	1750 x 486	750	903
TRP1100LNIM	1750 x 644	1100	1107
TRP1600LNIM	2070 x 671	1600	1514

Trough Round Unprotected^

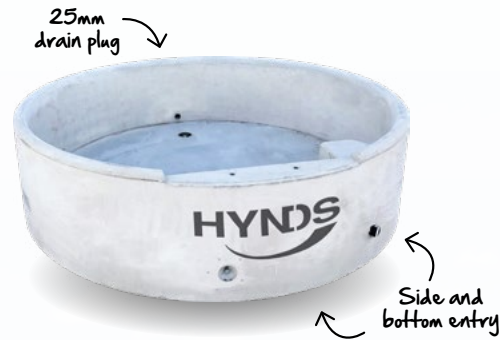

Hynds Code	Dimensions	Litres	Weight
TRU0515LNIM	1600 x 426	515	686
TRU0750LNIM	1750 x 486	750	847
TRU1100LNIM	1750 x 644	1100	1051
TRU1600LNIM	2070 x 671	1600	1410

Trough Oblong Protected

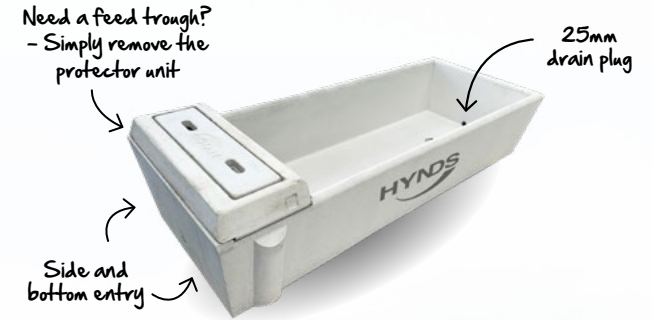

Hynds Code	Dimensions	Litres	Weight
TOP0250LNIM	1865 x 685 x 435	250	450
TOP0400LNIM	2100 x 870 x 435	400	591
TOP0550LNIM	2380 x 870 x 500	550	740



Hynds Pinnacle Trough Range

Our Pinnacle trough range has a lightweight recessed lid and chamberless design. This supports the use of higher flow rates while reducing wash back and bouncing of the ball valve.

Trough Round



TRU170

Hynds Code	Dimensions	Litres	Weight
TRU170^	1050 x 340	170	298
TRP180N	1120 x 410	180	388

Trough Oblong Protected*

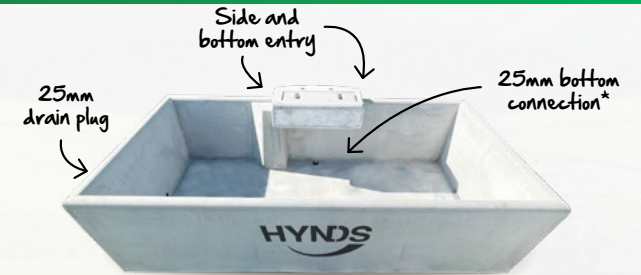

Hynds Code	Dimensions	Litres	Weight
TOP1100LNIM	2400 x 1300 x 600	1100	1200

*South Island version has an additional inlet in the underside, allowing for a bottom valve connection. Designed to reduce the impact of freezing temperatures.

Items can be transferred between islands, however minimum order quantities will apply.

North Island^

South Island^v

