

Hawle Synoflex Couplers and Flange Adaptors

Technical Guide W5.12

Fully restrained, this is a multifit pipe coupling and flange adaptor system suited to most pipe materials.



05.22 | W5.12 HAWLE SYNOFLEX COUPLERS

Applications

Pump stations
Treatment plants
Pipelines
Pipe repairs

Product Attributes

Fits most common pipe materials
Restraint coupler and flange adaptor
Wide fitting range
Reversible bolts
Accommodates up to 4 degrees of mis-alignment each end

Approvals/Standards

Kiwa BRL-K 775/03
EN 14525:2004
Flanges drilled to AS4087 B5
RAL Quality Mark RAL-GZ 662/2

Quality

ISO 9001 Quality
Management Systems

We are the supply partner of choice for New Zealand's civil construction industry, specialising in water and infrastructure based solutions.

An easy to install quality range of restraint couplings and flange adaptors from Hawle. High tolerance range to accept most pipe materials with separate torque zones, reversible stainless steel captive fasteners and full end restraint.



FIG. 1

Product Attributes

- Can connect all common types of pipe
- Restraint coupler and flange adaptor
- Wide fitting range
- Reversible bolts
- Allows for up to 4 degrees of mis-alignment each end
- Hawle 10 Year “Quality Warranty” when in use on potable water applications
- Patented restraint system
- Liner not required for SDR11, SDR13.6 PE pipes
- Liner may be required for SDR17 and thinner walled PE pipes, and thin walled PVC pipes, or pipes under vacuum.

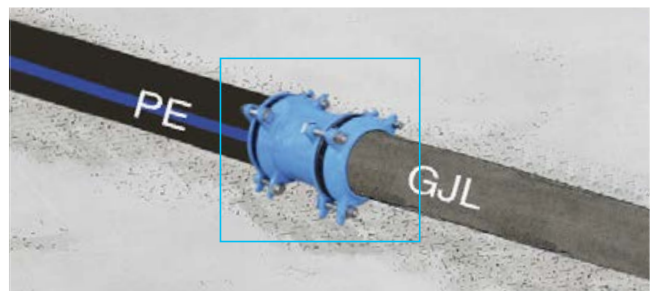

FIG. 2 Synoflex coupler

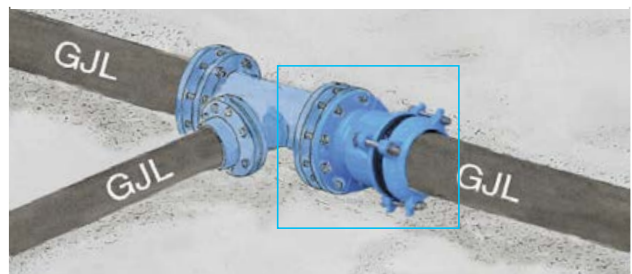

FIG. 3 Synoflex flange adaptor



Synoflex flange adaptor

Socket / Flange adaptor for all common types of pipe (DI, PE, PVC*, Steel)

***Note:** Caution must be taken on thin-wall PVC pipes and lines subjected to vacuum. In these situations, a liner may be required.

Features

- Flanges drilled according to AS4087 Figure B5
- Body and lock ring of ductile iron EN-GJS-400 epoxy powder coated
- Flexible elastomer gasket to EN681-1 (suitable for potable water)
- Flexible Synoflex ring of POM
- Tension locks of 316 stainless steel
Each support element holds a tension lock element
- Bolts and nuts of 316 stainless steel, with Molybdenum anti-seize coating
- Bolt head locking devices of 316 stainless steel, with protective cap of elastomer
- Reversible bolts
- Spacer bush made of plastic
- Angle compensation max. 4°



FIG. 4

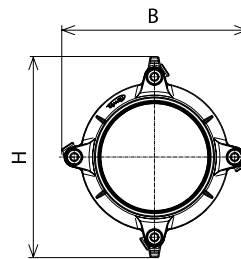

FIG. 5

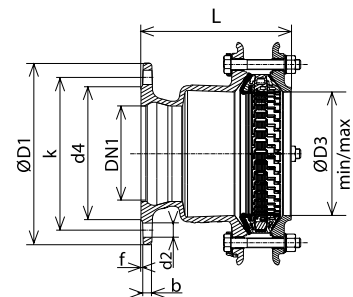

FIG. 6

Synoflex connector

Restrained system for various kinds of pipes (DI, PE, PVC*, Steel)

***Note:** Caution must be taken on thin-wall PVC pipes and lines subjected to vacuum. In these situations, a liner may be required.

Features

- Body and lock ring of ductile iron EN-GJS-400 epoxy powder coated
- Flexible gasket of elastomer to EN 681-1 suitable for potable water
- Flexible Synoflex ring of POM
- Tension locks of stainless steel. Each support element holds a tension lock element
- Bolts and nuts of stainless steel, with Molybdenum anti-seize coating
- Bolt head locking devices of stainless steel A4 with protective cap of elastomer
- Reversible bolts
- Spacer bushes of plastic
- Angle compensation max. 8° (+/- 4° each socket)



FIG. 7

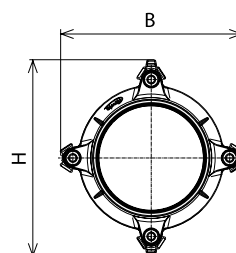

FIG. 8

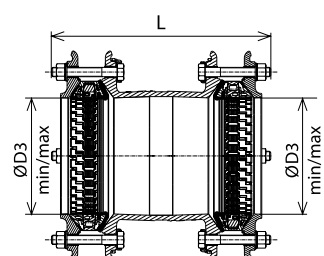

FIG. 9

TABLE 1 Synoflex flange adaptor - Socket / Flange adaptor for various kinds of pipes (DI, PE, PVC, Steel)

Item Code	Flange	Socket	PN	Pipe øD3	Flange					Flange Bolts			Body				Weight kg
	DN1	DN		min/max	øD1	k	d4	b	f	Qty.	Thread	d2	B	H	L	Bolts	
FASYN050-C	50	50	16	56 - 71	150	114	98	14	4	4	M16	18	141	170	203	3xM12-80	5.1
FASYN065-C	65	65	16	71 - 88	165	127	118	14	4	4	M16	18	156	187	203	3xM12-80	6.1
Indent	80	65	16	71 - 88	185	146	133	14	4	4	M16	18	156	187	203	3xM12-80	6.3
FASYN080-C	80	80	16	85 - 105	185	146	133	14	4	4	M16	18	171	204	193	3xM12-80	7.1
Indent	80	100	16	104 - 132	185	146	133	14	4	4	M16	18	226	260	263	3xM12-100	10.2
Indent	100	80	16	85 - 105	215	178	153	14	4	4	M16	18	171	204	188	3xM12-80	7.4
FASYN100-C	100	100	16	104 - 132	215	178	153	14	4	4	M16	18	226	260	228	3xM16-100	10.8
Indent	100	125	16	131 - 160	215	178	153	14	4	4	M16	18	250	290	278	3xM16-110	13.2
FASYN125-C	125	125	16	131 - 160	250	210	183	14	4	8	M16	18	250	290	248	3xM16-110	13.2
Indent	150	125	16	131 - 160	280	235	209	14	4	8	M20	18	250	290	245	3xM16-110	14
FASYN150-C	150	150	16	155 - 192	280	235	209	14	4	8	M16	18	315	350	258	4xM16-110	16.7
FASYN200-C	200	200	16	198 - 230	335	292	264	15	4	8	M16	18	326	405	277	6xM16-120	24.8
FASYN200A-C	200	225	16	230 - 260	335	292	264	15	4	8	M16	18	361	445	322	6xM20-130	31.4
FASYN250-C	250	250	16	265 - 310	405	356	319	20	4	8	M20	22	408	499	335	6xM20-130	42.7
FASYN300-C	300	300	16	313 - 356	455	406	367	22	4	12	M24	28	510	510	344	8xM20-130	59.1
Indent	350	350	10	352 - 396	520	470	427	24	4	16	M24	26	550	550	358	12xM20-130	71
Indent	400	400	10	398 - 442	580	521	477	25	4	16	M24	26	596	596	373	12xM20-130	83

TABLE 2 Synoflex connector - Socket / Socket connector for various kinds of pipes (DI, PE, PVC, Steel)

Item Code	Socket 1	Socket 2	PNaAZ	Socket 1				Socket 2					Weight kg
	DN	DN		B	H	Pipe øD3 min/max	Bolts	B	H	Pipe øD3 min/max	Bolts	L	
GIBCSYN050	50	50	16	141	170	56 - 71	3xM12-80	141	170	56 - 71	3xM12-80	254	4.9
GIBCSYN065	65	65	16	156	187	71 - 88	3xM12-80	156	187	71 - 88	3xM12-80	264	5.6
GIBCSYNR8065	80	65	16	171	204	85 - 105	3xM12-80	156	187	71 - 88	3xM12-80	274	6.6
GIBCSYN080	80	80	16	171	204	85 - 105	3xM12-80	171	204	85 - 105	3xM12-80	270	6.9
GIBCSYNR10080	100	80	16	226	260	104 - 132	3xM16-100	171	204	85 - 105	3xM12-80	312	9.7
GIBCSYN100	100	100	16	226	260	104 - 132	3xM16-100	226	260	104 - 132	3xM16-100	332	12.5
GIBCSYNR125100	125	100	16	250	290	131 - 160	3xM16-110	226	260	104 - 132	3xM16-100	355	14.3
GIBCSYN125	125	125	16	250	290	131 - 160	3xM16-110	250	290	131 - 160	3xM16-110	357	14.9
GIBCSYNR150100	150	100	16	315	350	155 - 192	4xM16-110	226	260	104 - 132	3xM16-100	361	16.7
GIBCSYNR150125	150	125	16	315	350	155 - 192	4xM16-110	250	290	131 - 160	3xM16-110	375	17.4
GIBCSYN150	150	150	16	315	350	155 - 192	4xM16-110	315	350	155 - 192	4xM16-110	367	19.3
GIBCSYNR200150	200	150	16	326	371	198 - 230	6xM16-120	315	350	155 - 192	4xM16-110	431	41.8
GIBCSYN200	200	200	16	326	371	198 - 230	6xM16-120	326	371	198 - 230	6xM16-120	406	30.2
GIBCSYNR225200	225	200	16	361	410	230 - 260	6xM20-130	326	371	198 - 230	6xM16-120	450	61.3
GIBCSYN230	225	225	16	361	410	230 - 260	6xM20-130	361	410	230 - 260	6xM20-130	429	41
GIBCSYNR250200	250	225	16	408	464	265 - 310	6xM20-130	326	371	198 - 230	6xM16-120	468	42.4
GIBCSYN250	250	250	16	408	464	265 - 310	6xM20-130	408	464	265 - 310	6xM20-130	441	48.6
GIBCSYN300	300	300	16	510	510	313 - 356	8xM20-130	510	510	313 - 356	8xM20-130	460	60
Indent	350	350	10	550	550	352 - 396	12xM20-130	550	550	352 - 396	12xM20-130	502	82.6
Indent	400	400	10	596	596	398 - 442	12xM20-130	596	596	398 - 442	12xM20-130	523	95.4

Branches Nationwide Support Office & Technical Services 0800 93 7473

Disclaimer: While every effort has been made to ensure that the information in this document is correct and accurate, users of Hynds product or information within this document must make their own assessment of suitability for their particular application. Product dimensions are nominal only, and should be verified if critical to a particular installation. No warranty is either expressed, implied, or statutory made by Hynds unless expressly stated in any sale and purchase agreement entered into between Hynds and the user.